

INTERIORS & ARCHITECTURE – Material | Products | People | Projects

SURFACES®

WWW.SURFACES.IN

REPORTER

August 2017 • ₹ 250 • INDIA
Published on 1st August 2017

100+ PAGES Inspiration
60+ PAGES Projects
13 VENEER Designs
12 FACADE Designs
11 STONE Works
5 FURNITURE Innovations
4 FLOORING Designs
3 MATERIAL Poetries
1 AND ONLY SHIRISH BERI

With Projects from

Ar. Shigeru Ban, Ar. Shirish Beri, Ar. Sanjay Puri, Ar. Sunil Gambani
Colin Seah, Ar. Misha Sharma, Giles Miller, Claudio Vilarinho, Dan Stubbergaard
Shantanu Garg, Ar. Rohan Dawar, Raja Architects Hyderabad, Ar. Manuj Agarwal
Mansi Pandey, Ar. Shefali Shrupali, Jaime Hayon, Ar. Moon Hoon, and more
RISING STAR Ar. Divyang A. Mevada, Formwerkz, Surat

RACE ROBOTICS LAB, SINGAPORE

Graphics & Interior Design by MOD | 243 sqm | SINGAPORE | BUILT 2017



Each facet comprises stacked layers of hand-cut aluminium hollow tubing; rotating the direction of the tubes with every facet to create a bold multi-directional effect

GO, GO, MR. ROBOTO

Ministry Of Design (MOD) was commissioned to design the branding and spatial experience for RACE, a new robotic facility aimed at educating, and introducing robots into automating manufacturing industries. RACE intended to feature a series of interchangeable modular robots as a key unique proposition.

BRANDING

Inspired by the concept of modularity, and influenced by aesthetics of precision and dynamism; the logotype is an expression of a complete form comprised of individual standalone parts.

SPATIAL EXPERIENCE

The brief for the laboratory space required flexibility to showcase a changing series of modular robots as well as be used for hands-on training and lectures. The laboratory needed to be a continuous open space, yet conducive for small clusters for hands-on training. Underpinning this brief, MOD also sought to create an engaging and future-forward spatial experience that denotes the idea of industrial automation and precision.

Upon arrival at the lift lobby, a vivid prelude to the laboratory space greets the viewer. A web of soaring white lines cut through the black space to create an anamorphic experience to disorient the floor from the ceiling.



COLIN SEAH

Director of Design and Founder
Ministry of Design
Singapore

*Colin Seah is an Internationally Acclaimed Lifestyle Design Thought Leader. Colin has been named **Designer of the Year** by International Design Awards USA 2010 and is a two-time recipient of Singapore's highest accolade, The President's Design Award.*

*Colin is also a two-time Grand Prize Winner of the **Gold Key Award**, the highest International Hospitality Accolade, named Hong-Kong Perspectives's "**40 under 40 architects**" and Marcus Corporation Foundation Prize 2007 "**emerging architect for potential for greatness**".*

*Recognized as "**Rising Star in Architecture**" by Monocle, Colin Seah has been invited by the **Singapore Tourism Board** to redefine Singapore as a destination for 2020 and beyond.*



MOD also sought to create an engaging and future-forward spatial experience that denotes the idea of industrial automation and precision





- 01 LIFT LOBBY
- 02 ENTRANCE VESTIBULE
- 03 ENTRENCE
- 04 TEACHING-LECTURE AREA
- 05 DISPLAY COUNTER
- 06 SERVICE HATCH
- 07 PROJECTOR SCREEN
- 08 STORE ROOM
- 09 TOILET

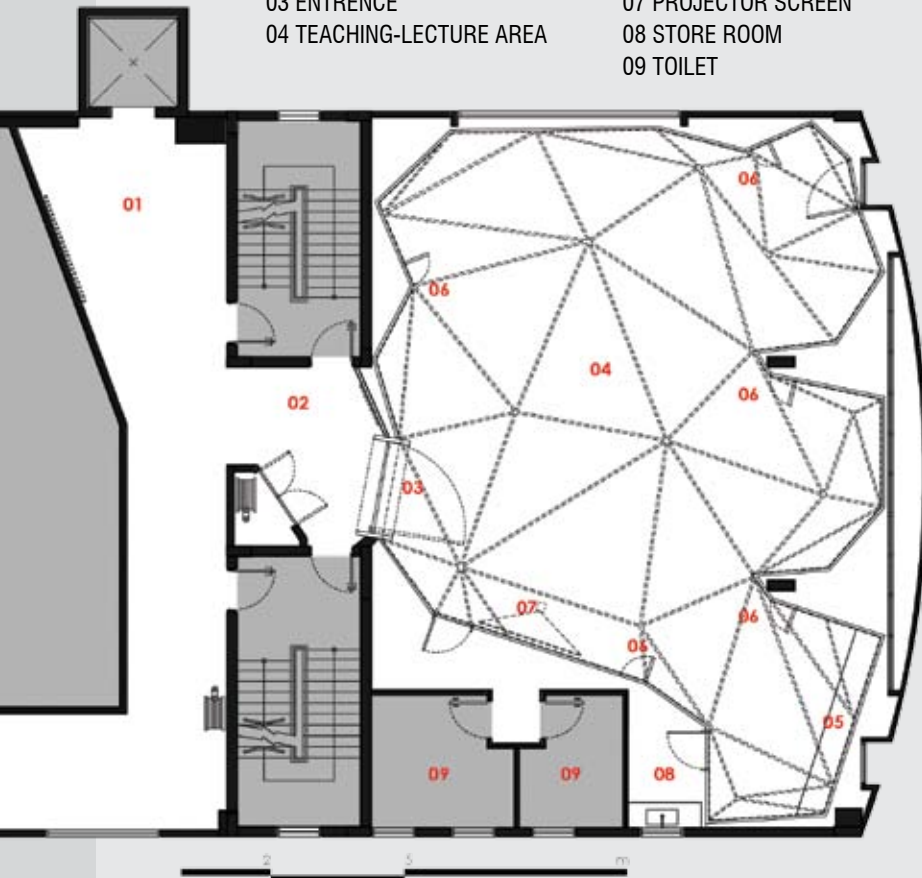

From the black envelope of the lift lobby, a custom oversized door pivots open to reveal a dramatic metallic faceted space, creating a contrast that is at once striking yet complementary.

For maximum flexibility to the space, MOD introduced a “second” skin - developed to seamlessly create a dynamic space by deconstructing the ceiling and wall planes into an array of dazzling facets. Each facet comprises stacked layers of hand-cut aluminium hollow tubing; rotating the direction of the tubes with every facet to create a bold multi-directional effect.

The aluminium screen cladding also serves to cloak the necessary but unsightly mechanical and electrical services while allowing ease of access for operation. This skin was shaped in plan with enclaves for small group work clusters accompanied by separate access hatches to the services behind. The random sprinkle of custom LED strips serves to highlight the multi-directional panels with a cutting-edge aesthetic. Overall, the space provides a suitable future-forward backdrop to usher in an age of automation and robotics.